

PRESENTING

THE STRINGS OF NEW BEGINNING



CIVITECH
STRINGS
SECTOR-12, GREATER NOIDA



PERFECTLY POSITIONED

Located in
Sector 12, Greater Noida

1

Created with **70% of open, green, and creative space**

2

Well-served by **Metro** and **local transportation**

3

Close to **prestigious schools, hospitals, recreational facilities, and banks**

4

Well-connected to **adjacent cities, towns, markets, and highways**

5

Civitech Strings, a premium and affordable collection of apartments, combines contemporary modernity and timeless style. Thoughtfully designed 2 and 3 bedroom apartments with spectacular views, clean air, and lush green surroundings. Civitech Strings is a tranquil, fully integrated gated residential complex with four spaciouly constructed towers nestled amid nature and fresh air.

Living in Civitech Strings means you're constantly in the thick of things, right in the heart of the city.

All specifications, designs, layout, images, conditions are only indicative and some of these can be changed at the discretion of the builder/architect/authority. These are purely conceptual and constitute no legal offerings.

RERA Reg No. UPRERAPRJ646272 | www.up-rera.in



**CIVITECH
STRINGS**
SECTOR-12, GREATER NOIDA

STYLISH, CONTEMPORARY ARCHITECTURE



Earthquake
resistant structure

1



North-East facing
corner plot

2



Convenient Shopping
within reach

3



Podium-based towers
for the calm and noise-free
environment due to no vehicular
movement near the flats.

4



Perfectly appointed in a prime location, Civitech Strings features four captivating towers. It is designed to seamlessly connect with its surroundings with its sweeping floor-to-ceiling windows. Each flat is filled with natural light through open flow-through layouts and boasts a captivating and soothing view of stunning green lush outdoors and surroundings. A feeling of fresh breath, peacefulness, and privacy at all corners.

All specifications, designs, layout, images, conditions are only indicative and some of these can be changed at the discretion of the builder/architect/authority. These are purely conceptual and constitute no legal offerings.

RERA Reg No. UPRERAPR3646272 | www.up-rera.in

CIVITECH
STRINGS
SECTOR-12, GREATER NOIDA





ULTIMATE MODERN COMFORT

-  Air-Conditioned Gymnasium **1**
-  24 hours water supply **2**
-  Power backup **3**
-  Spectacular Party Halls **4**
-  Intercom facility **5**
-  24x7 CCTV surveillance **6**
-  3 tier Security **7**



Convenient, comfortable, and thoughtfully executed amenities designed to extend the control of your home. Civitech Strings make sure you experience the utmost comfort. From beautifully landscape podium-based green spaces to a myriad of amenities, Civitech Strings offers everything you could need to enhance your day to day life.

All specifications, designs, layout, images, conditions are only indicative and some of these can be changed at the discretion of the builder/architect/authority. These are purely conceptual and constitute no legal offerings.
RERA Reg No. UPRERAPRJ646272 | www.up-rera.in



THE ONE AND ONLY CIVITECH STRINGS



Civitech Strings combines life-enriching comforts and impressive designs in a green, enriching surrounding. With thoughtfully created spaces and stylish yet affordable finishes, four towers at Strings provide distinctive lifestyles without compromising comfort, privacy, quality of life, and affordable luxury.

Step into a world where the ordinary meets the extraordinary, where home extends beyond the walls that liberate you. From the great expanses of serenity that stretch most naturally to the roaring delights of premium living at affordable prices, the residence at Civitech Strings satisfies your imagination.

All specifications, designs, layout, images, conditions are only indicative and some of these can be changed at the discretion of the builder/architect/authority. These are purely conceptual and constitute no legal offerings.
RERA Reg No. UPRERAPRJ646272 | www.up-rera.in

CIVITECH
STRINGS
SECTOR-12, GREATER NOIDA

HIGH-STYLE LIVING

SITE - MAP

1. Entrance / Exit Gate Complex
2. Arrival Court
3. Entrance Water Feature with Feature Wall
4. Jogging / Cycling Track
5. Tower Drop-off
6. Banquet Drop-off
7. Open Car Parking
8. Cricket Net Practice
9. Screen for ESS
10. Jogging / Cycling Track
11. Kids' Play Area
12. Pathway Through Portals
13. Badminton Courts (2 Nos.)
14. Pool Deck
15. Loungers Under Trellis
16. Main Swimming Pool
17. Kids' Pool
18. Water Feature at Knife Edge
19. Open Showers (3 Nos.)
20. Changing Rooms
21. Foot-over Bridge for Jogging Track at Podium Level
22. Palm Court
23. Plumeria Garden
24. Half Basketball Court
25. Sand Pit for Toddlers
26. Open Air Theater (O.A.T.)
27. Tensile Canopies above Sitting Tiers
28. Yoga / Meditation Garden
29. Central Green Area
30. Elders' Sitting Area
31. Fragrance Garden
32. Skating Rink
33. Outdoor Sitting



- 3BHK TYPE-1** (1275 Sq. ft.)
- 3BHK TYPE-2** (1250 Sq. ft.)
- 2BHK** (1090 Sq. ft.)

2 & 3 BHK apartments complex are invitation to live the life one desires and imagines, inspired by pure enjoyment and defined by sophisticated style and generous amenities.

Super Built-up area: The constructed areas of the project comprise the apartment's Polly line area and other constructed areas of common use. All specifications, designs, layout, images, conditions are only indicative and some of these can be changed at the discretion of the builder/architect/authority. These are purely conceptual and constitute no legal offerings. 1sqm = 10.764 sq. ft.

RERA Reg No. UPRERAPRJ646272 | www.up-rera.in





MAKE YOURSELF COMFORTABLE INSIDE AND OUTSIDE WITH ELEGANT TOUCHES.

Electrical

- Copper wiring concealed in PVC conduits
- Modular switches in entire flat & protective MCBs
- Adequate light and power points
- Provision for TV outlet in living room

Plumbing

- All internal plumbing in GI/CPVC/Composite (As per standard practice)

Lift Lobby & Corridors

- Granite / Marble / Anti-skid Tile
- High-speed lifts
- Two staircases in each tower
- Stone flooring on staircases

Security & FTTH

- Perimeter security & entrance lobby security with CCTV cameras
- Provision for Optical Fibre Network
- Fire prevention, detection & alarm system as per Fire Norms

Clubhouse & Sports Facilities

- Clubhouse with swimming pool with change rooms, open shower area, multi-purpose hall, indoor games like TT, cards room, pool table & well-equipped

Gym

- Outdoor games area, Badminton Court, Half kids' basketball court, cricket net-practice pitch, etc
- Jogging track, skating rink, OAT, meditation area, yoga area on podium & kids' play area



CIVITECH
STRINGS
SECTOR-12, GREATER NOIDA

All specifications, designs, layout, images, conditions are only indicative and some of these can be changed at the discretion of the builder/architect/authority. These are purely conceptual and constitute no legal offerings.

RERA Reg No. UPRERAPR3646272 | www.up-rera.in



THE SANGEET CLUB FOR MIND AND SOUL



 Fully AC Gym

1

 Party Hall

2

 Yoga Centre

3

 Game Room

4

 Library

5

 Swimming Pool

6

Sangeet, the uber-chic Club House at Strings, is the ultimate for self-indulgence. The vibe and the experience are one-of-a-kinds. Sangeet has it all, including a world-class fitness center that caters to every aspect of your personality, whether a gym nut, a yoga enthusiast, a sports connoisseur, a book worm, or a swimmer. The clubhouse will surely envy all your friends at other gated societies nearby.

All specifications, designs, layout, images, conditions are only indicative and some of these can be changed at the discretion of the builder/architect/authority. These are purely conceptual and constitute no legal offerings.

RERA Reg No. UPRERAPRJ646272 | www.up-rera.in

CIVITECH
STRINGS
SECTOR-12, GREATER NOIDA

THERE ARE MYRIAD REASONS TO BE HAPPY, AND ONE OF THEM IS CONVENIENCE!



Parikrama, the commercial ensures that everything is just around the corner and within reach at Civitech Strings. Parikrama is a one-stop-shop for everyday utility products, grocery, farm produce, stationery, food outlets, medical services, salons, and so on. As everything is available under one roof, staying at Strings is a distinct advantage for individuals who live there.



All specifications, designs, layout, images, conditions are only indicative and some of these can be changed at the discretion of the builder/architect/authority. These are purely conceptual and constitute no legal offerings.

RERA Reg No. UPRERAPR3646272 | www.up-rera.in





2 BHK

Super Area: 101.26 sq. Mt.
(1090 sq. Ft.)

Built Up Area: 80.61 sq. Mt.
(868 sq. Ft.)

Carpet Area: 57.10 sq. Mt.
(615 sq. Ft.)

Drawing-cum-Dining

2 Bedrooms

Kitchen

2 Toilets

4 Balconies

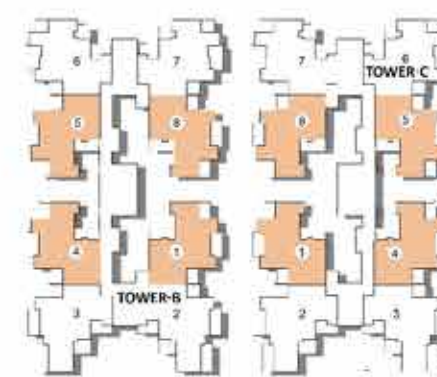

Super Built-up area: The constructed areas of the project comprising of polly line area of the apartment and other constructed areas of common use. All specifications, designs, layout, images, conditions are only indicative and some of these can be changed at the discretion of the builder/architect/authority. These are purely conceptual and constitute no legal offerings. 1sqm = 10.764 sq. ft.

RERA Reg No. UPRERAPRJ646272 | www.up-rera.in



STRINGS OF CIVITECH DEVELOPERS

Built on a legacy of 25 plus years of honored commitments, integrity, innovation, and timely delivery of quality projects. Since 1995, well-known to be regarded among the few finest and leading real estate companies in Delhi NCR. Civitech is still rooted in its humble beginning to address each customer's customized needs and experiences. Civitech believe houses are made with emotions and feelings instead of bricks and mortar.

Under the leadership of visionary Mr. Subodh Goel team has strived to be customer-centric, focused and transparent in all aspects to client relationship. We make sure to carry forward the heritage of trust, quality, and transparency in each home we deliver you.



LOCATION MAP

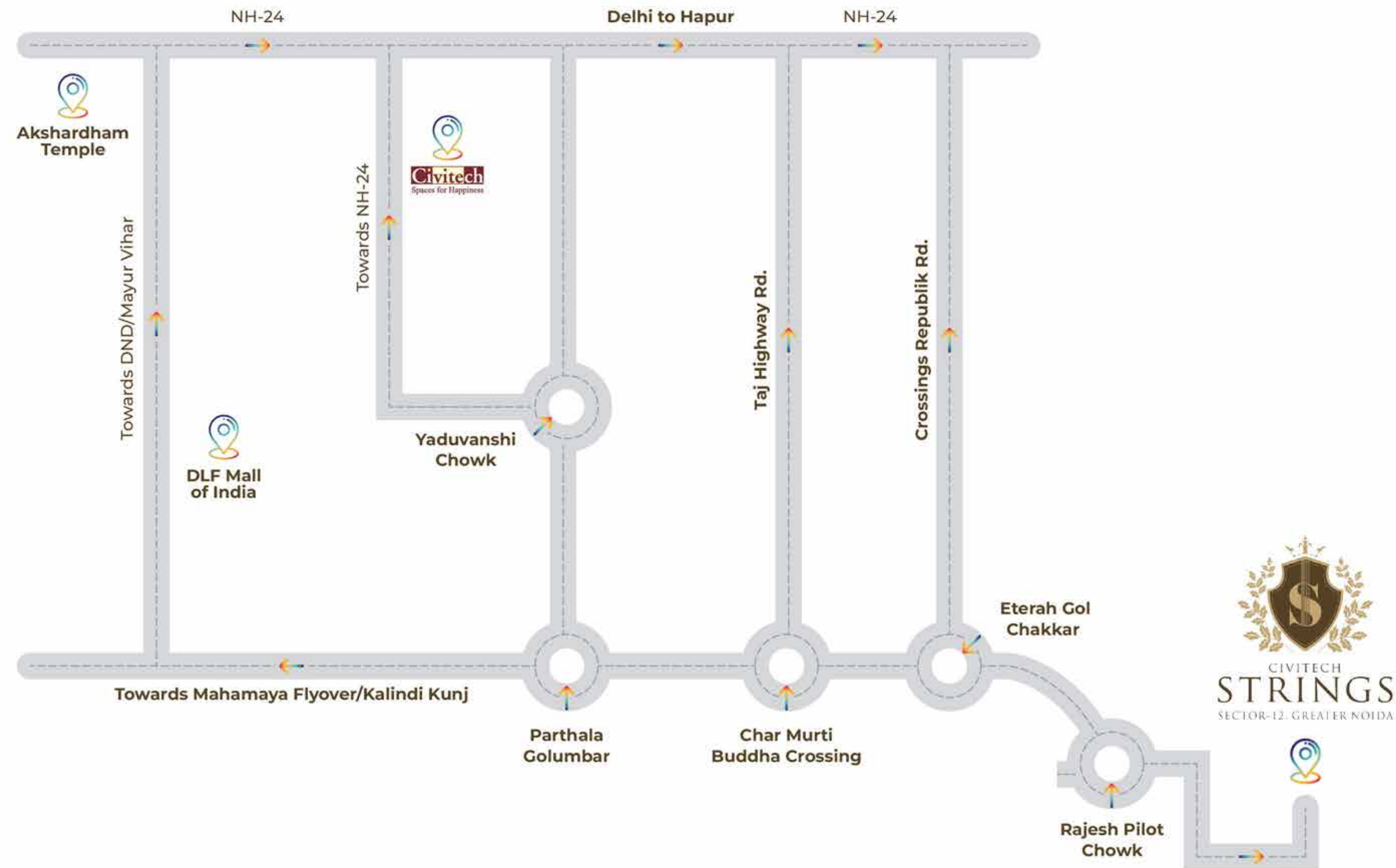

EVERY NOTE OF LIFE IS CLOSE BY

 **On the Noida-Gr. Noida Link Road**

1

 **Next to upcoming metro station**

2

 **20 minutes from Noida City Centre**

3

 **15 minutes drive to NH-24**

4

 **5 minutes drive to Char Murti Chowk**

5

We are delighted to welcome you to the Happy Big and Growing Civitech Family!



Civitech

Spaces for Happiness

SAG Realtech Private Limited (Civitech Group of Companies)

Corporate Office: Civitech House, H-71, Sector-63, Noida (UP)

Site Office: GH-2B, Sector-12, Greater Noida (UP)

www.civitech.in

RERA Reg No. UPRERAPRJ646272 | www.up-rera.in